

PROPOSED EXPANSION LAYOUT

Terminal Expansion



Project Phasing

Phase 1
Substantial Completion: Dec 31, 2024



Phase 2
Substantial Completion: September 2025



Note: Expansion and Enhancement Areas depicted in Red

0' 50' 100' 200'

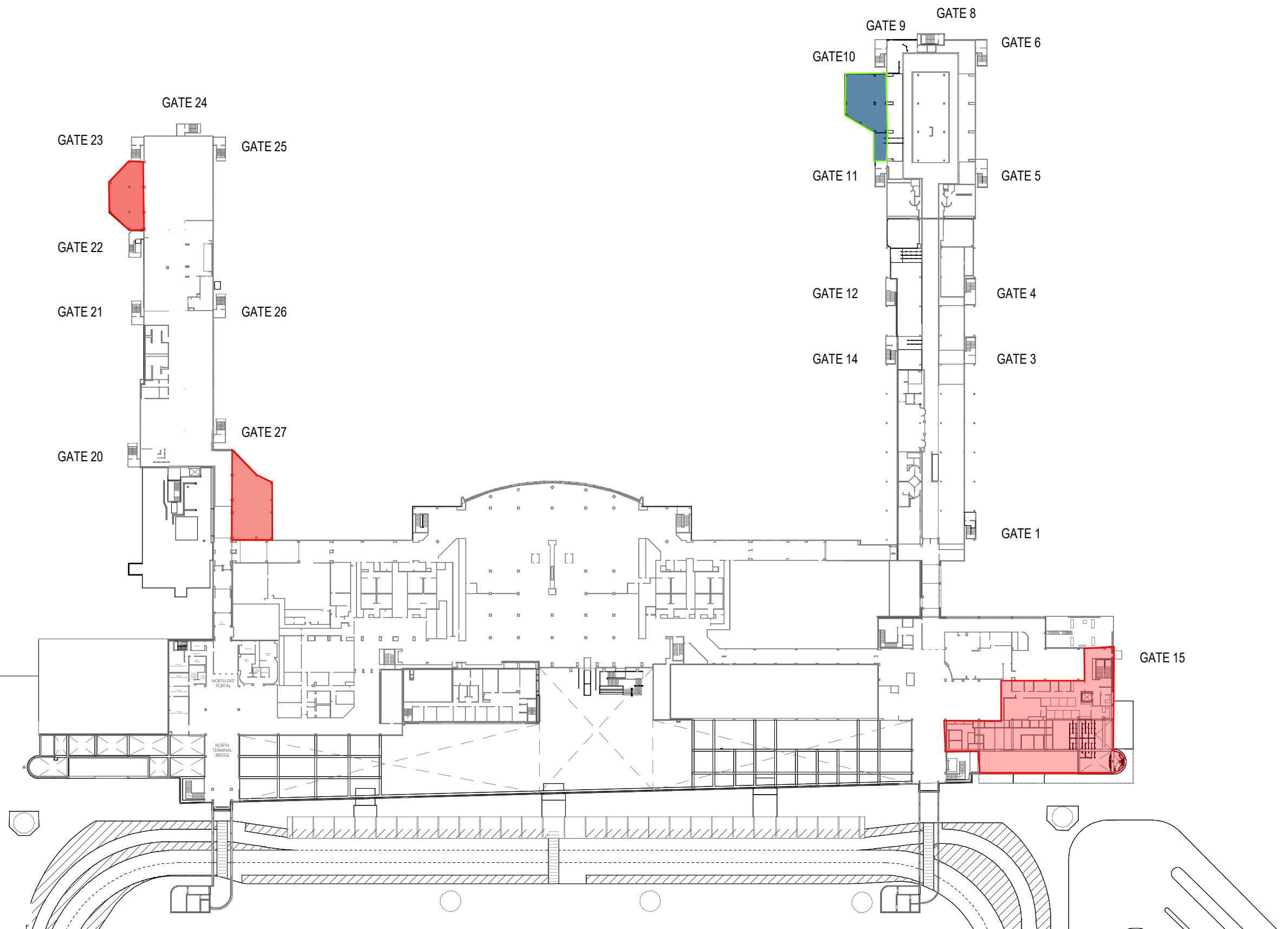

For Official Use Only - To request additional information, please contact bids@syrairport.org
Plans subject to change.