

ADDENDUM NO. 01 JUNE 5, 2023

1. INSTRUCTIONS TO ALL HOLDERS OF CONTRACT DOCUMENTS

TO ALL HOLDERS OF CONTRACT DOCUMENTS

Your attention is directed to the following interpretations of, changes and additions to the Contract Documents for the project, “Windows and Siding Replacement” at Syracuse Hancock International Airport (SYR) in Syracuse, New York.

This Addendum constitutes part of the Contract Documents. Should conflicts occur between the Specifications or Drawings with items in the Addendum, the Addendum shall govern. Bidders shall examine carefully all items and determine for themselves what sub-bidders are affected, and notify all bidders or sub-bidders of clarifications, interpretations, or revisions affecting their work. Work described in this Addendum shall be in accordance with specifications for like items unless stated otherwise.

2. 1.2 Intent and Purpose of this RFP

Replace entire paragraph with the following:

“The intent and purpose of this Request for Proposals (the “RFP”) is to solicit responses for the selection of a firm to provide assessment and replacement of the windows and siding on both the north and south concourses. The windows and siding are inefficient and need to be replaced.”

3. 1.3 Key Dates in the RFP Schedule:

Insert the following in chronological order in the schedule **Wednesday, June 7, 1:00 p.m.**
– **MANDATORY Walkthrough**

4. North and South Concourse Proposed Expansions

PROPOSED SEATING LAYOUT - SOUTH CONCOURSE GATES 11

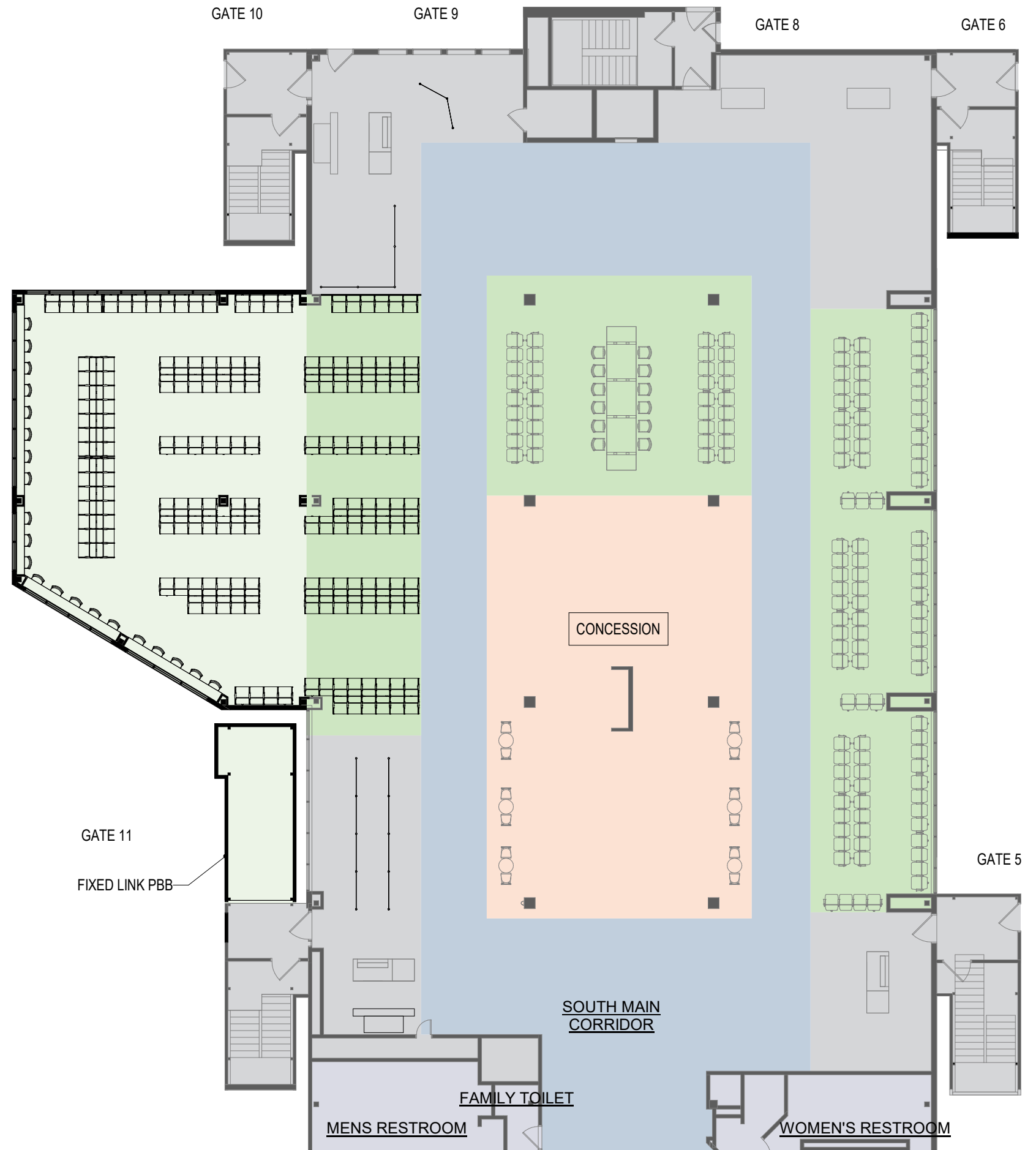

GATE SEATING COUNT		
	EXISTING	PROPOSED
GATE 9-11	99	189

- LEGEND**
- CIRCULATION
 - EXISTING HOLDROOM AREA
 - EXISTING CONCESSION
 - EXISTING NON-PROGRAM SPACES
 - EXISTING RESTROOM
 - NEW HOLDROOM AREA - 2,285 SQFT

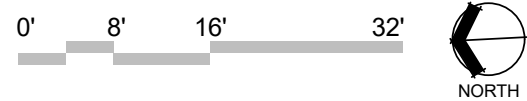

PROPOSED SEATING LAYOUT - NORTH CONCOURSE GATES 23-25

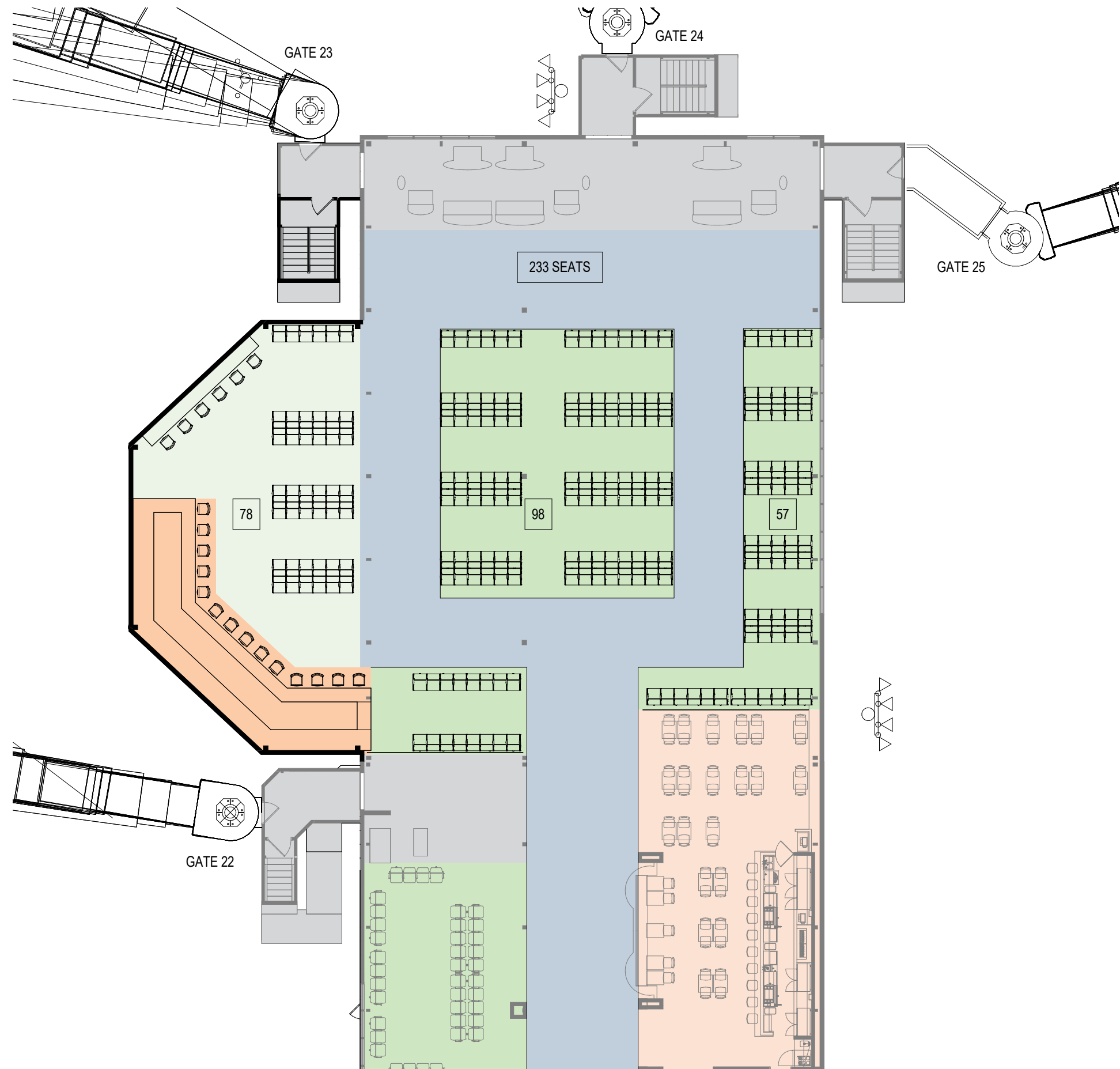

GATE SEATING COUNT			
	EXISTING	GRANT	PROPOSED
GATE 15	122	122	111
GATE 20	91	48	66*
GATE 23	45	79	78
GATE 24	104	104	98
GATE 25	48	48	57
GATE 27	0	100	86*
TOTAL:	410	501	526*

* ADDITIONAL ± 30 SOFT SEATING SPLIT BETWEEN GATES 20 & 27

LEGEND

- CIRCULATION
- EXISTING HOLDROOM AREA
- EXISTING CONCESSION
- EXISTING NON-PROGRAM SPACES
- EXISTING RESTROOM
- NEW HOLDROOM AREA - 1,200 SF
- NEW CONCESSION - 650 SF
- SOFT SEATING

0' 8' 16' 32'



PROPOSED SEATING LAYOUT - NORTH CONCOURSE GATES 20 & 27

GATE SEATING COUNT			
	EXISTING	GRANT	PROPOSED
GATE 15	122	122	111
GATE 20	91	48	66*
GATE 23	45	79	78
GATE 24	104	104	98
GATE 25	48	48	57
GATE 27	0	100	86*
TOTAL:	410	501	526*

* ADDITIONAL ± 30 SOFT SEATING SPLIT BETWEEN GATES 20 & 27

LEGEND

- CIRCULATION
- EXISTING HOLDROOM AREA
- EXISTING CONCESSION
- EXISTING NON-PROGRAM SPACES
- EXISTING RESTROOM
- NEW HOLDROOM AREA - 2,900 SF
- NEW CONCESSION - 1,150 SF
- SOFT SEATING

0' 8' 16' 32'

