

## ADDENDUM NO. 01 JUNE 12, 2023

### 1. INSTRUCTIONS TO ALL HOLDERS OF CONTRACT DOCUMENTS

TO ALL HOLDERS OF CONTRACT DOCUMENTS

Your attention is directed to the following interpretations of, changes and additions to the Contract Documents for the project, "HVAC Replacement" at Syracuse Hancock International Airport (SYR) in Syracuse, New York.

This Addendum constitutes part of the Contract Documents. Should conflicts occur between the Specifications or Drawings with items in the Addendum, the Addendum shall govern. Bidders shall examine carefully all items and determine for themselves what sub-bidders are affected, and notify all bidders or sub-bidders of clarifications, interpretations, or revisions affecting their work. Work described in this Addendum shall be in accordance with specifications for like items unless stated otherwise.

### 2. HVAC system equipment by Zone:

- **Zone 1 = North Concourse 1<sup>st</sup> Floor**
  - WSHP
  - North Cooling Tower
  - MAU 1-2 (roof)
    - 1 Kitchen HP MAU
    - 1 Kitchen Hood
- **Zone 2 = North Concourse 2<sup>nd</sup> Floor**
  - WSHP
  - MAU (roof) (out of service)
- **Zone 3 = South Concourse 1<sup>st</sup> Floor**
  - AC1 Trane DX Cooling – VAV System
  - Weil Boilers (2)
  - Control Air
  - (4) City Water Condenser (2 out of service)
    - AC-1CA, AC2-CA, AC -1BA, AC-2BA
  - Electric Boiler (out of service)
  - Air Handler with DX Cooling (Gate 14 Offices)
  - Liebert Split System (out of service)
  - FCU 3 (electric heat, chilled water coil)
  - Base Board Heat
- **Zone 4 = South Concourse 2<sup>nd</sup> Floor - Gates 1, 3, 12 & 14**
  - Carrier 30HX 94 Ton Cooling
  - FCU 1 & 2 (MAU OA Economizer)
  - Control Air Compressor

Syracuse Regional Airport Authority

p – 315.454.3263  
f – 315.454.8757  
info@syrairport.org

- South Cooling Tower
- **Zone 5 = South Concourse 2<sup>nd</sup> Floor – Gates 5, 6, 8, 9, 10 & 11**
  - South Roof
    - All roof top Carrier units 1 – 5
    - MAU (2 Out of Service)
- **Zone 6 = Main/Central Terminal**
  - North Roof Terminal McQuay (3) 500 Ton
  - Buderus Boilers (4)
  - AHU 1 - 11
  - RTU 1 – 19
  - Server Room
    - Trane DX Cooling Plus AHU
    - Admin Offices VAV Box's

**3. Updated Pricing Breakdown:**

<b>Zone</b>	<b>Lump Sum Price Per Zone</b>
1 – North Concourse 1 <sup>st</sup> Floor Design:	
1 – North Concourse 1 <sup>st</sup> Floor Construction:	
Demo	
Permitting	
New Equipment Cost	
Installation Cost	
<b>Total Zone Cost</b>	
2 – North Concourse 2 <sup>nd</sup> Floor Design:	
2 – North Concourse 2 <sup>nd</sup> Floor Construction:	
Demo	
Permitting	
New Equipment Cost	
Installation Cost	
<b>Total Zone Cost</b>	
3 – South Concourse 1 <sup>st</sup> Floor Design:	
3 – South Concourse 1 <sup>st</sup> Floor Construction:	
Demo	
Permitting	
New Equipment Cost	
Installation Cost	
<b>Total Zone Cost</b>	
4 – South Concourse 2 <sup>nd</sup> Floor - Gates 1, 3, 12 & 14 Design:	

4 – South Concourse 2 <sup>nd</sup> Floor - Gates 1, 3, 12 & 14 Construction:	
Demo	
Permitting	
New Equipment Cost	
Installation Cost	
<b>Total Zone Cost</b>	
5 – South Concourse 2 <sup>nd</sup> Floor – Gates 5, 6, 8, 9, 10 & 11 Design:	
5 – South Concourse 2 <sup>nd</sup> Floor – Gates 5, 6, 8, 9, 10 & 11 Construction:	
Demo	
Permitting	
New Equipment Cost	
Installation Cost	
<b>Total Zone Cost</b>	
6 – Main/Central Terminal Design:	
6 – Main/Central Terminal Construction:	
Demo	
Permitting	
New Equipment Cost	
Installation Cost	
<b>Total Zone Cost</b>	
<b>Task</b>	<b>Lump Sum Price</b>
<b>Design:</b>	
New Installation/Expansion Cost of BMS	
Instrumentation Drawings	
SCADA System	
<b>Total Design:</b>	
<b>Construction:</b>	
Demo	
Permitting	
Installation/Expansion and O&M Cost of BMS	
New Equipment Cost	
Installation Cost	
<b>Total Construction:</b>	
<b>Total Project Cost:</b>	

## **4. North and South Concourse Proposed Expansions**



# PROPOSED EXPANSION LAYOUT - DEPARTURES LEVEL

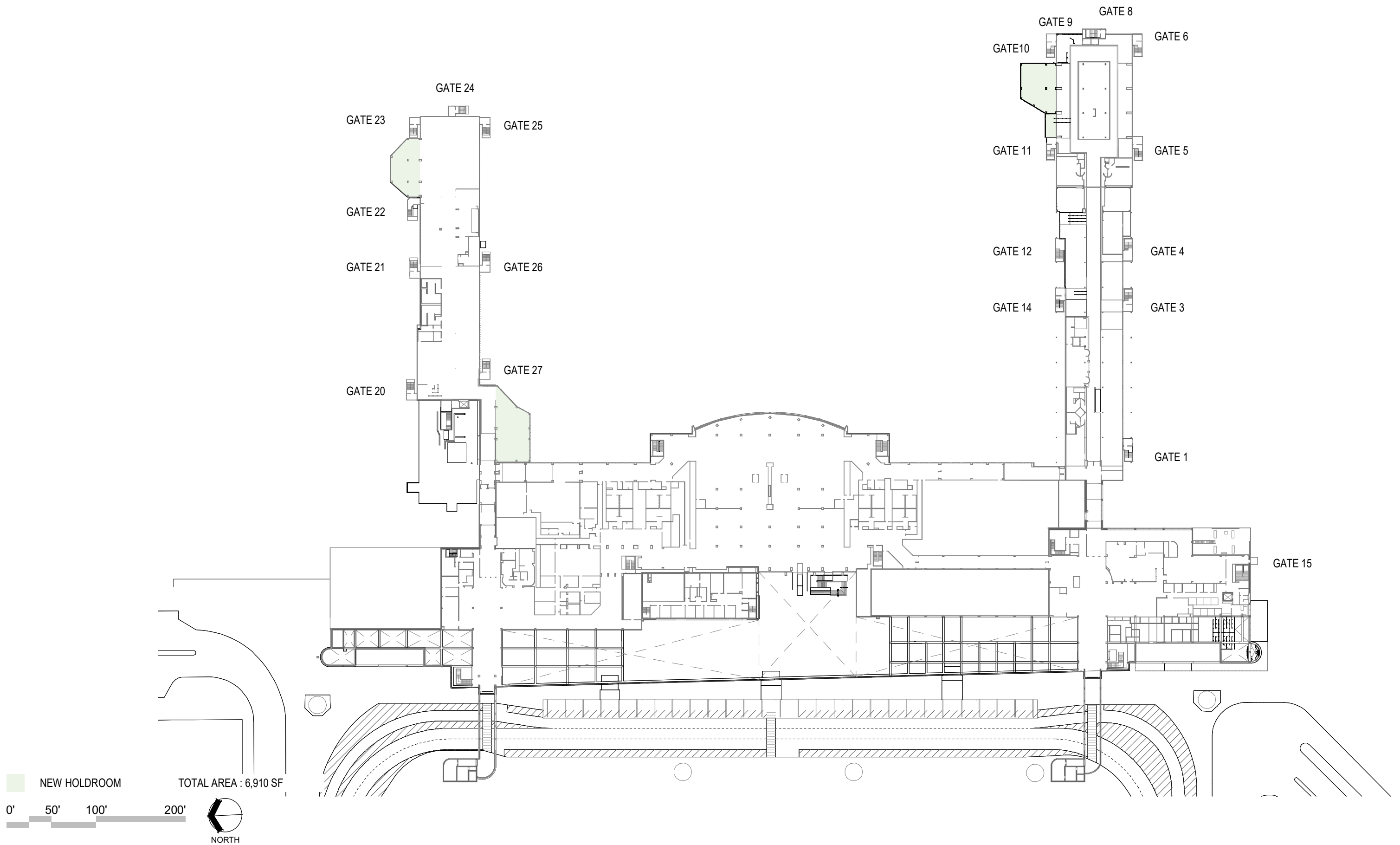

# PROPOSED SEATING LAYOUT - SOUTH CONCOURSE GATES 11

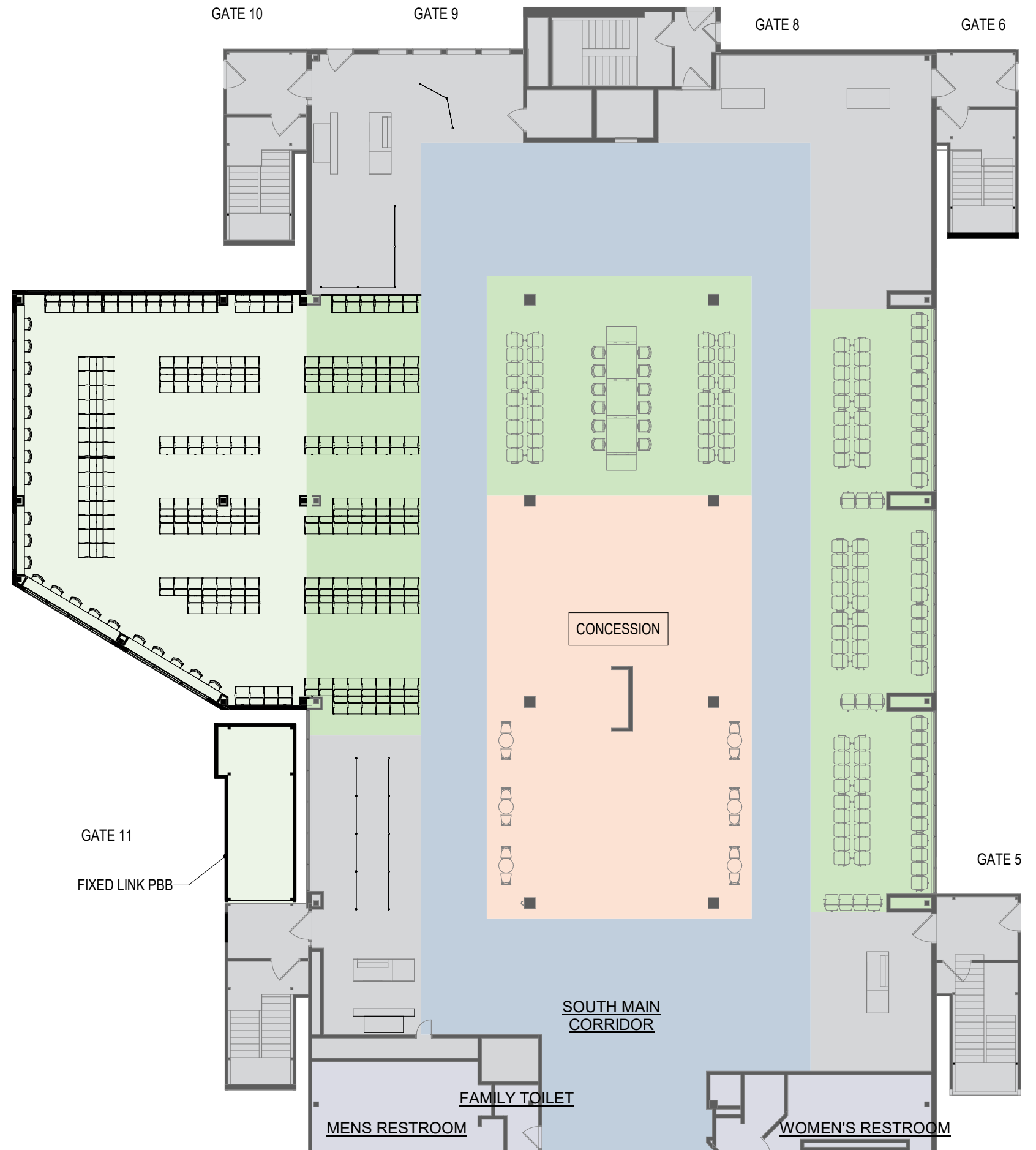

GATE SEATING COUNT		
	EXISTING	PROPOSED
GATE 9-11	99	189

- LEGEND**
- CIRCULATION
  - EXISTING HOLDROOM AREA
  - EXISTING CONCESSION
  - EXISTING NON-PROGRAM SPACES
  - EXISTING RESTROOM
  - NEW HOLDROOM AREA - 2,285 SQFT

0'    8'    16'    32'



# PROPOSED SEATING LAYOUT - NORTH CONCOURSE GATES 23-25

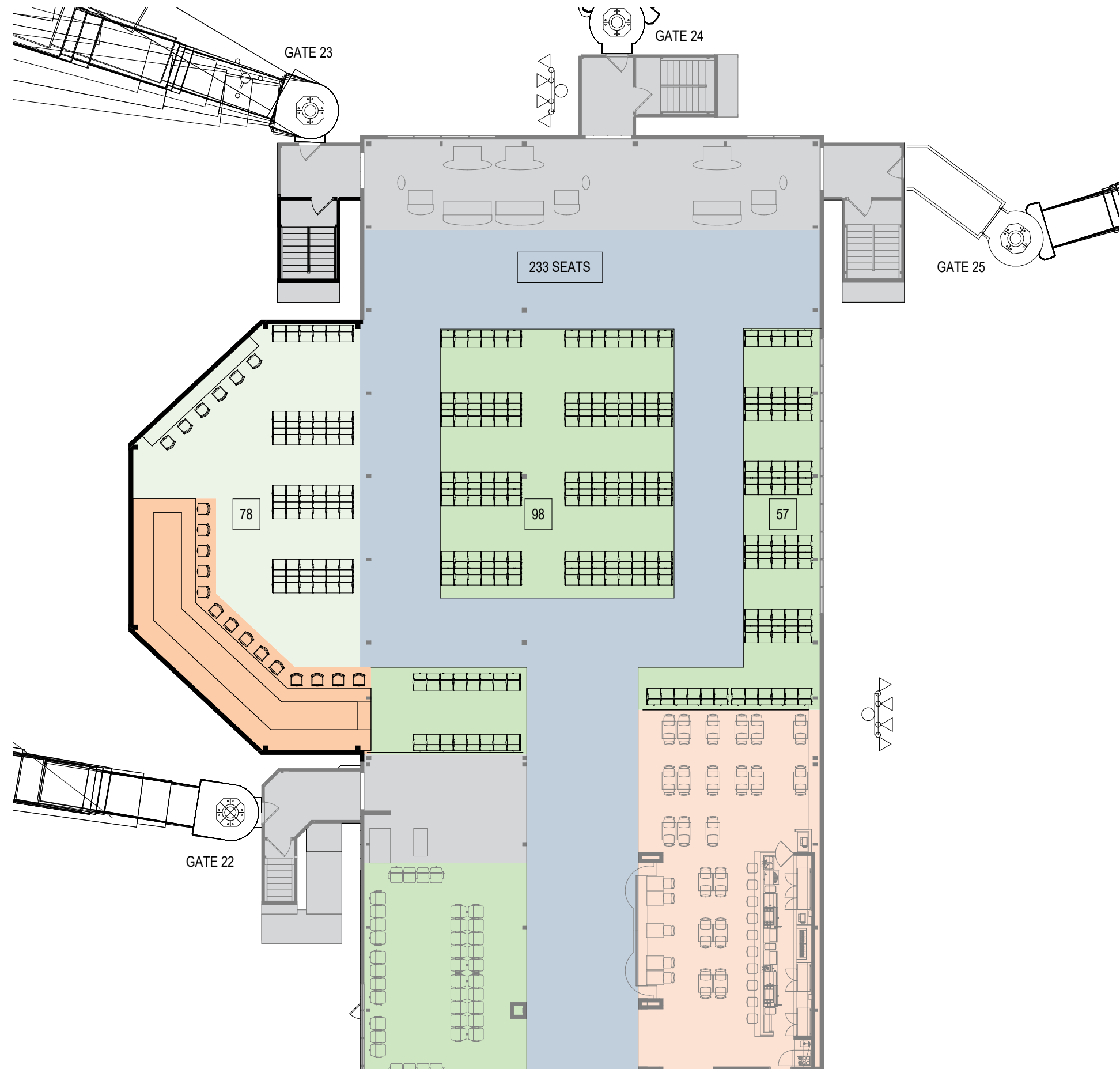

GATE SEATING COUNT			
	EXISTING	GRANT	PROPOSED
GATE 15	122	122	111
GATE 20	91	48	66*
GATE 23	45	79	78
GATE 24	104	104	98
GATE 25	48	48	57
GATE 27	0	100	86*
<b>TOTAL:</b>	<b>410</b>	<b>501</b>	<b>526*</b>

\* ADDITIONAL ± 30 SOFT SEATING SPLIT BETWEEN GATES 20 & 27

## LEGEND

- CIRCULATION
- EXISTING HOLDROOM AREA
- EXISTING CONCESSION
- EXISTING NON-PROGRAM SPACES
- EXISTING RESTROOM
- NEW HOLDROOM AREA - 1,200 SF
- NEW CONCESSION - 650 SF
- SOFT SEATING

0'    8'    16'    32'



# PROPOSED SEATING LAYOUT - NORTH CONCOURSE GATES 20 & 27

GATE SEATING COUNT			
	EXISTING	GRANT	PROPOSED
GATE 15	122	122	111
GATE 20	91	48	66*
GATE 23	45	79	78
GATE 24	104	104	98
GATE 25	48	48	57
GATE 27	0	100	86*
TOTAL:	410	501	526*

\* ADDITIONAL ± 30 SOFT SEATING SPLIT BETWEEN GATES 20 & 27

## LEGEND

- CIRCULATION
- EXISTING HOLDROOM AREA
- EXISTING CONCESSION
- EXISTING NON-PROGRAM SPACES
- EXISTING RESTROOM
- NEW HOLDROOM AREA - 2,900 SF
- NEW CONCESSION - 1,150 SF
- SOFT SEATING

0'    8'    16'    32'

