

ADDENDUM NO. 1

to the Contract Documents
for the Construction of the

SURFACE PARKING LOT EXPANSIONS

at

SYRACUSE HANCOCK INTERNATIONAL AIRPORT
SYRACUSE REGIONAL AIRPORT AUTHORITY
SYRACUSE, NEW YORK

IFB REFERENCE #2022-11

TO ALL HOLDERS OF CONTRACT DOCUMENTS:

Your attention is directed to the following interpretations of changes in and additions to the Contract Documents for the construction of the **SURFACE PARKING LOT EXPANSIONS** project at the Syracuse Hancock International Airport, Syracuse, New York. This Addendum is part of the Contract Documents in accordance with the provisions of Section 200-05, Addenda, and Interpretation.

GENERAL:

1. Refer to attached document for summary of responses to inquiries received.
2. The Bid Receipt Closing Date and time have changed.
3. Refer to attached pre-bid meeting minutes.

CONTRACT SPECIFICATIONS:

1. **Section 01 – Advertisement and Notice To Contractors**
 - a) For Bid Date, **DELETE** "Tuesday September 6, 2022, until 3:00 p.m." and **SUBSTITUTE THEREFORE** with "Friday September 9, 2022, until 1:00 p.m."
 - b) For all references to RFI Submittal Deadline, **DELETE** "August 31, 2022, by 3:00 pm" and **SUBSTITUTE THEREFORE** with "September 6, 2022, by 3:00 pm"
2. **Section 03 – Proposal**
 - a) **Statement of Surety's Intent** - project for which bids will be received on or before: **DELETE** "Tuesday September 6, 2022, until 3:00 p.m." and **SUBSTITUTE THEREFORE** with "Friday September 9, 2022, until 1:00 p.m."

3. **Section 100 – Instructions To Bidders**
 - a) **100-01 Bid Date: DELETE** "Tuesday September 6, 2022, until 3:00 p.m." and **SUBSTITUTE THEREFORE** with "Friday September 9, 2022, until 1:00 p.m."

4. **Section 200 – Information For Bidders**
 - a) **200-09 Proposals: DELETE** "Tuesday September 6, 2022, until 3:00 p.m." and **SUBSTITUTE THEREFORE** with "Friday September 9, 2022, until 1:00 p.m."

END OF ADDENDUM NO. 1

McFarland Johnson Engineering



Adam J. Frosino, P.E., Lic. No. 088870

Syracuse Regional Airport Authority
 Syracuse Hancock International Airport Authority
SURFACE PARKING LOT EXPANSIONS



**Response To Inquires
 IFB Reference 2022-11**

Item	Date	QUESTIONS	Date	RESPONSE
1	8/24/2022	Please consider extending the bid date to a minimum of 9/8.	8/26/2022	SRAA has extended the bid due date to: Friday, September 9, 2022, until 1:00 p.m."
2	8/25/2022	Can we please get a cost/estimate for this project? In order to get the bid bond underway we will need this information as to not hold anything up due to the short time frame to bid.	8/26/2022	A-1 - Base Bid Parking Lot #1: \$1.6M to \$1.8M A-4 - Add Alternative Parking Lot #2: \$450K to \$600K A-5 - Add Alternative Parking Lot #3: \$300K to \$ 400K
3	8/25/2022	Due to the fast turn around time required for this project, paving will be late in the year. Epoxy paint might not be option due to the temperatures. Can a substitution be made or would painting want to be delayed until Sprint?	8/26/2022	Using alternative paints would be acceptable if timing restricted the use of epoxy. Project should be bid with epoxy and if a less expensive alternative is required then a credit should be provided to the airport.
4	8/25/2022	Possible hold up might be City Permitting for the project.	8/26/2022	City Codes intake meeting and plans upload was 8/25/2022 based on their availability. We expect permits to be available in Priority order Lot#1, Lot#3, Lot#2, by the September NTP date. Contractors are responsible for obtaining the necessary permits and all fees associated. The City of Syracuse Fee Schedule for Permits may be located on the cities website: http://www.syrgov.net/pdfs/2/Fee%20Schedule.pdf

Item	Date	QUESTIONS	Date	RESPONSE
5	8/25/2022	Possible hold up might be electrical material for the project.	8/26/2022	All proposals will be evaluated on a best value basis. Firms/Contractors who elect to submit a proposal, must identify expected sub-contractors, material suppliers or vendors long lead times on the materials needed to complete the projects, and the projected delivery & installation dates.
6	8/25/2022	Is the prime contractor allowed to use their minority status to count toward the project if they are one?	8/26/2022	Yes, all contractors, vendors & suppliers minority status regardless of prime/sub, are counted towards the MWBE & SDVOB participation goals.
7	8/26/2022	Given the upcoming holiday, might it be possible to push the bid back at least a day or two so it isn't directly after the holiday?	8/26/2022	See Question & Response #1.

Item	Date	QUESTIONS	Date	RESPONSE
8	8/29/2022	on A-2, Bus Shelter - Add Alternative (Each Shelter Cost), is the lump sum price for each shelter or the 2 that are shown on SP-1?	8/30/2022	A-2 Bus Shelter- Add Alternate: Lump Sum Price is for EACH individual shelter
9	8/30/2022	I see on Lot #1 you have specified the BAA (Buy American Act) option but not for Lot #2 or Lot #3. Did you want this option for all three lots? The adder is only \$80 per fixture.	8/30/2022	The Buy American Act option (BAA) shall apply to the fixtures for <u>all lots</u> .
10	8/30/2022	Also Lot #1 is specified at 480V and Lots #2 and #3 are specified at universal 120-277V which is fine but I wanted to confirm.	8/30/2022	The light fixtures in Lots 2 & 3 shall also be 480 Volt.
11	8/30/2022	The details on DT-2, what is listed on the bid form & the fence we believe we're tying into....all do not match each other. Which type of fence should this be bid with?	8/30/2022	Bid fence per the details on sheet DT-2 of the design plans.

Item	Date	QUESTIONS	Date	RESPONSE
12	8/30/2022	Please confirm that the owner is providing the fence fabric as per Note 1/ DT-2.	8/30/2022	Note 1/DT-2 is incorrect and shall be deleted, Owner is not providing fence fabric. Contractor(s) shall provide and include new fence fabric in the bid.
13	8/30/2022	Can you confirm the unclassified ex can be used as embankment. All existing berms in place are 100% topsoil and cannot be used as embankment.		Suitable unclassified excavation material may be used as embankment to construct berms. Suitable topsoil within the existing berms may be used for establishing turf.

**Syracuse Hancock International Airport
Surface Parking Lot Expansion(s)
Project Pre-Bid Meeting Minutes – August 30, 2022 (11:00 A.M.)**

I. Sign-in Sheet:

See attached meeting sign-in sheet.

II. Project Description:

The project has been divided into a Base Bid and four (4) Add Alternatives to maximize use of available funds. A general description of the major work associated with each bid alternative is as follows:

- A-1 – Parking Lot #1 Construction - Base Bid – Phase 1A:
 - Install new perimeter security fencing
 - Demolish existing perimeter security fencing

- A-1 – Parking Lot #1 Construction - Base Bid – Phase 1B:
 - Install temporary construction fence
 - Install temporary erosion control measures
 - Strip topsoil and stockpile
 - Perform mass excavation and embankment
 - Construct stormwater control facilities
 - Install electric and communication utilities (conduits & manholes)
 - Install light pole foundations
 - Install storm drainage structures, pipes, and end sections
 - Install stone diaphragm and underdrain pipes
 - Fine grade and proof roll subgrade
 - Place geotextile fabric
 - Construct 12-inches of Type 2 Subbase (NYSDOT Item 304.12)
 - Construct 2.5-inches of Binder Course (NYSDOT Item 402.198904)
 - Sawcut and mill existing pavement and construct pavement key
 - Construct 1.5-inches of Surface Course (NYSDOT Item 402.098204)
 - Construct asphalt sidewalks
 - Install revenue control equipment and gates to be provided by others
 - Install bus shelter(s) if Add Alternate A-2 is awarded
 - Install new light poles and light fixtures
 - Remove and replace existing light fixtures if Add Alternate A-3 is awarded
 - Install new signposts and signage
 - Install permanent pavement markings
 - Establish turf and restore all disturbed areas to pre-existing conditions

- A-2 – Parking Lot #1 – Bus Shelter - Add Alternative:
 - Supply and install bus shelter(s) in Lot #1

- A-3 – Parking Lot #1 – Replacement of Light Fixtures - Add Alternative:
 - Remove existing light fixtures in employee parking lot (poles to remain)
 - Supply and install new light fixtures on existing poles

- A-4 – Parking Lot #2 Construction - Add Alternative:
 - Install temporary construction fence
 - Install temporary erosion control measures
 - Strip topsoil and stockpile
 - Perform mass excavation and embankment
 - Construct stormwater control facilities
 - Install electric and communication utilities (conduits & manholes)
 - Install light pole foundations
 - Install stone diaphragm and underdrain pipes
 - Construct concrete island for access control equipment
 - Fine grade, compact, and proof roll existing stone subbase
 - Construct 2.5-inches of Binder Course (NYSDOT Item 402.198904)
 - Sawcut and mill existing pavement and construct pavement key
 - Construct 1.5-inches of Surface Course (NYSDOT Item 402.098204)
 - Construct asphalt sidewalks
 - Install revenue control equipment and gates to be provided by others
 - Install new light poles and light fixtures
 - Install new signposts and signage
 - Install permanent pavement markings
 - Establish turf and restore all disturbed areas to pre-existing conditions

- A-5 – Parking Lot #3 Construction - Add Alternative:
 - Install temporary construction fence
 - Install temporary erosion control measures
 - Strip topsoil and stockpile
 - Perform mass excavation and embankment
 - Construct stormwater control facilities
 - Install electric and communication utilities (conduits & manholes)
 - Install light pole foundations
 - Fine grade and proof roll subgrade
 - Place geotextile fabric
 - Construct 12-inches of Type 2 Subbase (NYSDOT Item 304.12)
 - Construct 2.5-inches of Binder Course (NYSDOT Item 402.198904)
 - Sawcut and mill existing pavement and construct pavement key
 - Construct 1.5-inches of Surface Course (NYSDOT Item 402.098204)
 - Construct asphalt sidewalks
 - Install bus shelter(s) if Add Alternate A-2 is awarded
 - Install new light poles and light fixtures
 - Remove and replace existing light fixtures if Add Alternate A-3 is awarded
 - Install new signposts and signage
 - Install permanent pavement markings
 - Establish turf and restore all disturbed areas to pre-existing conditions

III. Relationships

- | | | |
|-----------|------------------------|---|
| A. | The Owner: | Syracuse Regional Airport Authority |
| B. | Grant Agencies: | None |
| C. | Engineer: | McFarland-Johnson, Inc. |
| D. | Contractor: | To be awarded as a single contract with Syracuse Regional Airport Authority |

IV. Items included in the Bid

The contract bid items include in general:

A. Maintenance and Protection of Traffic:

1. In order to enhance safety during construction and minimize impacts on Airport operations caused by construction, the Base Bid Parking Lot #1 work has been divided into two (2) phases and separate Add Alternatives for Parking Lot #2 and #3 work:

a. Phase 1A (A-1-Base Bid) – Security Fence Work

- Parking Lot #1 Work Area ‘A’ - 15 Calendar Days
- Entrance through Gate 108 (cargo) off Air Cargo Road with construction access crossing only closed pavements
- Access route must be delineated utilizing colored traffic cones

b. Phase 1B (A-1-Base Bid) – Parking Lot #1 Construction

- Parking Lot #1 Work Area ‘B’ – 75 Calendar Days
- Access will be through existing employee parking lot entrance off Air Cargo Road
- Existing employee parking lot entrance shall remain active during the entire work period
- Air Cargo Road shall remain active during the entire work period (shoulder closures are allowed but should be kept to the minimum time needed).
- When minimum lane width of 10 feet cannot be maintained due to shoulder closures flaggers will need to be provided to maintain traffic flow.

c. (A-4-Add Alternate) – Parking Lot #2 Construction

- Parking Lot #2 Work Area – 90 Calendar Days
- Access will be through a new stabilized construction entrance off Air Cargo Road
- Air Cargo Road shall remain active during the entire work period (channelized lane closure and shoulder closure are allowed but should be kept to the minimum time needed).
- When minimum lane width of 10 feet cannot be maintained due to shoulder closures flaggers will need to be provided to maintain traffic flow.

d. (A-4-Add Alternate) – Parking Lot #3 Construction

- Parking Lot #3 Work Area – 90 Calendar Days
- Access will be through a new stabilized construction entrance off Air Cargo Road
- Air Cargo Road and Col. Eileen Collins Blvd. shall remain active during the entire work period (channelized lane closure and shoulder closure are allowed but should be kept to the minimum time needed).

2. Liquidated damage clauses have been included for work beyond the completion times of individual phases and are as follows:
 - A-1 – Base Bid \$1,500 per Calendar Day or portion thereof for incomplete work items beyond 90 Calendar Days
 - A-2 – Add Alternate \$1,500 per Calendar Day or portion thereof for incomplete work items beyond 5 Calendar Days
 - A-3 – Add Alternate \$1,500 per Calendar Day or portion thereof for incomplete work items beyond 5 Calendar Days
 - A-4 – Add Alternate \$1,500 per Calendar Day or portion thereof for incomplete work items beyond 90 Calendar Days
 - A-5 – Add Alternate \$1,500 per Calendar Day or portion thereof for incomplete work items beyond 90 Calendar Days
3. All vehicles operating inside the perimeter security fence shall be appropriately marked including a 3' x 3' orange and white checkered flag during the day, and amber rotating beacons at night. All vehicles shall be staged / stored in the designated work area or staging area.

B. Project Survey and Stakeout:

- All work must be performed under the direction of a New York State licensed surveyor.
- Contractor should review NYSDOT Section 625 and M-150 in the specifications to become familiar with acceptable survey methods.

C. Excavation and Embankment:

- The contractor should familiarize themselves with the compaction requirements within NYSDOT Section 203.
- Unclassified excavation includes stripping of topsoil.

D. Pavements:

- The pavement base course is a NYSDOT Item 304.12 crushed aggregate base course.
- The bituminous pavements items are NYSDOT specified mixes.
- There are no cost escalation clauses included in the contract.

E. Electrical, Communication, and Lighting Improvements:

- The contractor should familiarize themselves with the Utility, Power, Communications, & Control Plans, Lighting Plan, and Details of the Design Plans; and Division 26 – Electrical and Division 27 – Communications specifications of the contract documents.

F. Pavement Markings:

- The contractor should familiarize themselves with the permanent pavement marking requirements within NYSDOT Section 640.

G. Contractor's Schedule:

- The project is scheduled such that construction will start in the fall of 2022. It is anticipated that Phase 1A and 1B will begin in late-September. If awarded, Add Alternate A-2 and A-3 will follow the completion of the Base Bid Phase 1B work. If awarded, Add Alternate A-4 and A-5 will run consecutively with the Base Bid Phase 1A and 1B work. Refer to the Preliminary Construction Schedule in Section 011000 – Summary of Work.
- As per Section 011000 of the Contract Specifications, Contractor shall provide a detailed construction schedule for all work activities. This schedule shall be submitted to the Engineer for review during the Pre-Construction meeting. The schedule shall be maintained throughout the project to the satisfaction of the Engineer.

H. General Requirements:

- Construction vehicles shall use the designated haul routes at all times during the course of construction.
- Stored materials will be reimbursed by the Owner; however, the contractor shall meet the requirements for the stored material payment including paid receipts for the item, it needs to be stored on site in a secured location and protected.
- There are existing lighting and communication circuits within the work areas. Cables servicing active circuits shall be required to remain in service to the greatest extent practicable. Splicing of new circuits into existing circuits will be coordinated through the engineer and airport operations.

V. Additional Considerations/Topics –

A. Airport Access

- Gates: The contractor shall coordinate all ingress and egress locations and/or access with Airport Operations and the Resident Engineer
- Badging: Employees and Subcontractors working within the Airport Operations Area (AOA) will be issued a security badge by the Authority. Lost badges will result in a fine of \$1000 per badge if they are not returned to the airport. The contractor shall also be required to provide a list of vehicles that will require access to the construction site. All vehicles are subject to search.
- Haul Routes: During hauling operations, the contractor shall be restricted to the haul routes shown on plans. The current phasing program does not require the contractor to cross any active airfield pavements although the security fence work and access along the Service Road will require an escort from Airport Operations.

- Spoils: Excess spoil material from earthwork operations shall be hauled off site.

B. General Requirements for review

- Bonding and Insurance – the Contractor is directed to review the requirements for insurance and bonding.
- Prevailing Wages – The State wage rate schedule is included in the contract documents, refer to Attachment A to Section 700.
- M/WBE Goal – 30.0%
- SDOVB Goal – 6.0%
- Prime bidders are required to submit a list for the prime and all subcontractor’s that lists the firm’s name, address, whether or not the firm is a certified M/WBE or SDOVB firm, age of firm, and annual gross receipts with bids.
- Adam Frosino, afrosino@mjinc.com (MJ) – Design Interpretations
- Proposal Submission:
 - Bid Proposals will be received by the offices of the Executive Director; of the Syracuse Regional Airport Authority **until 3:00 pm, local time, on Tuesday, September 6th, 2022.**
 - All bidders shall submit an original and one (1) copy of all required documents. Copied documents shall be clearly marked “COPY” and bound as a complete set.

C. Addendum Items

- Pre-bid meeting minutes will be submitted as an addendum

VI. Open Discussion

1. Contractor Question: Was there a geotechnical investigation done, if so, can we get a copy of the report?
Answer: Yes, a geotechnical investigation was done, a copy of the results are attached to the meeting minutes.



Syracuse Hancock International Airport
 Project Pre-Bid Meeting 08/30/22
 Surface Parking Lot Expansion(s)



Name, Title, and Company	Mailing Address	Phone / Fax / Email
Tim Bailey, PE	49 Court Street	Phone: 607-727-0800
Senior Project Manager	Suite 240	Fax: 607-723-4979
McFarland-Johnson, Inc.	Binghamton, NY 13901	Email: tbailey@mjinc.com
Lorne Watson	15 Fishers Rd	Phone: 585-905-0970
Engineer	Suite 200	Fax: 607-723-4979
McFarland-Johnson, Inc.	Pittsford, NY 14534	Email: lwatson@mjinc.com
Danny Clark Estimator Villager Construction	425 Old Macedon Center Rd Fairport NY	585 857 4870 akohna@villagerci.com
Andrew Spring Estimator / Project Manager O'Connell Electric	7001 Performance Dr. North Syracuse, NY 13214	Phone: (315) 383-0771 Fax: Email: andrew.spring@oconnellelectric.co
Brian Dorman SRAA		Phone: 315 - 961 - 2036 Fax: Email: borman b@syraairport.org
DANIEL ZENK SRAA		Phone: 315-391-5808 Fax: Email: ZENK@SYRAAIRPORT.ORG
Beth Cooper SRAA		Phone: 315-466-6495 Fax: Email: Cooper@syraairport.org
STEPHEN COMPAGNI Economy Parking Co.	1819 Rt. 13 Cortland NY	Phone: 607 788 2219 Fax: Email: scamp@economyparking.com



Syracuse Hancock International Airport
 Project Pre-Bid Meeting 08/30/22
 Surface Parking Lot Expansion(s)



Name, Title, and Company	Mailing Address	Phone / Fax / Email
Tony Legnetto Project Man Paul F. Vitale, Inc	7655 North St. Rd Auburn, NY 13021	Phone: 315 253-9797 Fax: 315 253-9798 Email: TLegnetto@VitalCompanyS.com
Jim Jay Mary Excavation	5835 St Rt 5 Herkimer NY 13350	Phone: 315 749-9593 Fax: Email: Joy@maryexcavation.com
JIM BAKER VP JBS DIRT INC	7901 GEE ROAD CAMASTOTA NY 13032	Phone: 315-697-7114 Fax: 315-697-8619 Email: jbsdirtdirt@koc.com
Aaron Harris SPAA OPERATIONS	1000 COL. ELLIOTT COLLEGE CAMP	Phone: 315 753 9135 Fax:
MARK MATURCZAK Industry Standards USA	Liverpool, NY	Phone: 315-679-0350 Fax: Email: markm@industrystandardsusa.com
Reggie Meeks Seneca Stone Corp	Seneca Falls NY	Phone: 585-760-3327 Fax: Email: RMECKS@SenecaStone.com
Tim McMahon SRAA		Phone: 315 3915802 Fax:
John Heine SRAA		Phone: 315-455-3634 Fax: Email: heinej@syriehair.com



*Syracuse Hancock International Airport
Project Pre-Bid Meeting 8/30/22
Surface Parking Lot Expansion(s)*



Name and Title	Affiliation	Email
Brian Dorman Director of Planning and Development	Syracuse Regional Airport Authority (SRAA)	dormanb@syrairport.org
Adam Frosino Project Manager	McFarland Johnson	afrosino@mjinc.com
Bill Verfuss Airfield Practice Leader - SME	McFarland Johnson	wverfuss@mjinc.com



PW Laboratories, Inc.

6544 Fremont Road - East Syracuse, New York 13057

Office 315.437.1420 ~ Fax 315.503-3058 ~ pwlabsinc@hotmail.com

June 22, 2022

Mr. William E. Verfuss, PE
McFarland-Johnson, Inc.
15 Fisher Road
Pittsford, New York 14534

Re: L-22090
Syracuse Hancock International Airport
Parking Lot Expansion
Syracuse, New York

Dear Mr. Verfuss [WVerfuss@mjinc.com]:

Enclosed are the results of field testing performed at your request for the above referenced project. Results include:

1) Test Boring using 2-inch O.D. Split Spoon Sampler Advanced by Hollow Stem Augers (ASTM D1586) 6 Each

The Test Borings were performed by *Northeast Specialized Drilling (NSD)* under the direction of *PW Laboratories, Inc.*

Thank you for this opportunity to work with you.

PW LABORATORIES, INC.

A handwritten signature in black ink, appearing to read 'P Edmiston', written in a cursive style.

Patrick J. Edmiston
Laboratory Manager
PJE/bll

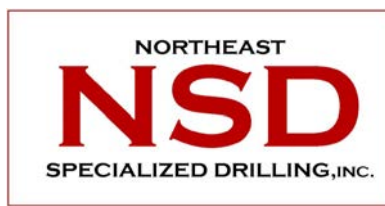

BORING LOG

PROJECT:	Syracuse Airport Parking Expansion Project	JOB NUMBER:	G029-22 PW Labs#L-22-0090
LOCATION:	Air Cargo Road - Syracuse, New York	BORING NUMBER:	B-1
CLIENT:	PW Laboratories, Inc.	SURFACE ELEVATION:	As Obtained by Client

GROUND WATER READINGS			
DATE STARTED:	06/21/22	DATE COMPLETED:	06/21/22
DRILLER:	Marc Cheney	HELPER:	Zack Cheney
CASING TYPE:	2 1/4" Hollow Stem Augers		WHILE DRILLING:
DRILL RIG:	Truck Mounted Central Mine Equipment Model 55		BEFORE CASING REMOVED:
			AFTER CASING REMOVED:
			CAVED AT DEPTH:

SAMPLE NUMBER	DEPTH OF SAMPLE	BLOW COUNTS OF SAMPLER DRIVE (per 6")	C/N	RECOVERY (Inches)	DESCRIPTION OF SOIL (Color, Primary Matrix, Complementary Matrix)	DEPTH OF STRATA CHANGE
1a	0.0'-0.6'	1-4-5-5	N/9	7	7" Topsoil (moist)	0.6
1b	0.6'-2.0'			8	Brown fine SAND, little SILT (moist, loose)	
2	2.0'-4.0'	5-5-4-5	N/9	22	Similar Soil (moist, loose)	
3	4.0'-6.0'	2-2-3-3	N/5	24	Similar Soil (wet, loose)	
4	6.0'-8.0'	3-2-1-1	N/3	18	Similar Soil (wet to saturated, very loose)	
5	8.0'-10.0'	2-4-4-5	N/8	21	Similar Soil (saturated, loose)	
					Bottom of Boring @ 10.0'	

Notes: 1. Offset boring 3.0' - Augered to 4.5' bgs and set a 4" Infiltration Test Pipe. Client to perform testing.
Key to Drilling Terms: N - No. of blows to drive sampler 12" w/ 140 lb. hammer falling / 30"; C - % of Bedrock Core Recovery



BORING LOG

PROJECT:		Syracuse Airport Parking Expansion Project			JOB NUMBER:		G029-22 PW Labs#L-22-0090	
LOCATION:		Air Cargo Road - Syracuse, New York			BORING NUMBER:		B-2	
CLIENT:		PW Laboratories, Inc.			SURFACE ELEVATION:		As Obtained by Client	
GROUND WATER READINGS								
DATE STARTED:	06/21/22	DATE COMPLETED:	06/21/22	WHILE DRILLING:			Depth to Water:	Casing At:
							8.0'	8.0'
DRILLER:	Marc Cheney	HELPER:	Zack Cheney	BEFORE CASING REMOVED:			7.7'	8.0'
CASING TYPE:	2 1/4" Hollow Stem Augers			AFTER CASING REMOVED:			None Noted	
DRILL RIG:	Truck Mounted Central Mine Equipment Model 55			CAVED AT DEPTH:			1.4'	
SAMPLE NUMBER	DEPTH OF SAMPLE	BLOW COUNTS OF SAMPLER DRIVE (per 6")	C/N	RECOVERY (Inches)	DESCRIPTION OF SOIL (Color, Primary Matrix, Complementary Matrix)	DEPTH OF STRATA CHANGE		
1	0.0'-2.0'	6-11-13-18	N/24	18	Asphalt Millings (moist)			
					~Miscellaneous Fill~			
2a	2.0'-3.0'	18-13-6-5	N/19	12	Asphalt Millings (moist) ~Miscellaneous Fill~	3.0		
2b	3.0'-4.0'			3	Grey/Brown fine SAND, little SILT, trace fine GRAVEL (moist, medium compact)			
3	4.0'-6.0'	6-8-5-5	N/13	16	Brown mf SAND, little SILT (moist to wet, medium compact)			
4	6.0'-8.0'	3-2-1-1	N/3	24	Brown/Grey fine SAND, little SILT (wet to saturated, very loose)			
5	8.0'-10.0'	1-WH-1-WH	N/1	24	Grey fine SAND, trace SILT (saturated, very loose)			
					Bottom of Boring @ 10.0'			

Notes: 1. Offset boring 2.5' - Augered to 5.5' bgs and set a 4" Infiltration Test Pipe. Client to perform testing.

Key to Drilling Terms: N - No. of blows to drive sampler 12" w/ 140 lb. hammer falling / 30"; C - % of Bedrock Core Recovery

BORING LOG

PROJECT: Syracuse Airport Parking Expansion Project		JOB NUMBER: G029-22 PW Labs#L-22-0090					
LOCATION: Air Cargo Road - Syracuse, New York		BORING NUMBER: B-3					
CLIENT: PW Laboratories, Inc.		SURFACE ELEVATION: As Obtained by Client					
DATE STARTED:		DATE COMPLETED:		GROUND WATER READINGS			
				Depth to Water:	Casing At:		
06/21/22		06/21/22		WHILE DRILLING:		7.1'	8.0'
DRILLER: Marc Cheney		HELPER: Zack Cheney		BEFORE CASING REMOVED:		7.0'	8.0'
CASING TYPE: 2 1/4" Hollow Stem Augers				AFTER CASING REMOVED:		None Noted	
DRILL RIG: Truck Mounted Central Mine Equipment Model 55				CAVED AT DEPTH:		3.4'	
SAMPLE NUMBER	DEPTH OF SAMPLE	BLOW COUNTS OF SAMPLER DRIVE (per 6")	C/N	RECOVERY (Inches)	DESCRIPTION OF SOIL (Color, Primary Matrix, Complementary Matrix)	DEPTH OF STRATA CHANGE	
1a	0.0'-0.5'	3-2-2-4	N/4	6	6" Topsoil (moist)	0.5	
1b	0.5'-2.0'			10	Brown fine SAND, little SILT (moist, loose)	2.0	
2	2.0'-4.0'	4-5-4-5	N/9	19	Brown SILT, some fine SAND, trace Root Hairs (moist, stiff)	4.0	
3	4.0'-6.0'	3-3-2-2	N/5	23	Grey/Brown fine SAND, some SILT (wet to saturated, loose)		
4	6.0'-8.0'	1-WH-1-WH	N/1	24	Grey fine SAND, little SILT (saturated, very loose)		
5	8.0'-10.0'	2-1-3-2	N/4	24	Similar Soil (saturated, loose)		
					Bottom of Boring @ 10.0'		
Notes: 1. Offset boring 3.0' - Augered to 5.0' bgs and set a 4" Infiltration Test Pipe. Client to perform testing.							
Key to Drilling Terms: N - No. of blows to drive sampler 12" w/ 140 lb. hammer falling / 30"; C - % of Bedrock Core Recovery							

BORING LOG

PROJECT:	Syracuse Airport Parking Expansion Project	JOB NUMBER:	G029-22 PW Labs#L-22-0090
LOCATION:	Air Cargo Road - Syracuse, New York	BORING NUMBER:	B-4
CLIENT:	PW Laboratories, Inc.	SURFACE ELEVATION:	As Obtained by Client

GROUND WATER READINGS			
DATE STARTED:	06/21/22	DATE COMPLETED:	06/21/22
DRILLER:	Marc Cheney	HELPER:	Zack Cheney
CASING TYPE:	2 1/4" Hollow Stem Augers		WHILE DRILLING:
DRILL RIG:	Truck Mounted Central Mine Equipment Model 55		BEFORE CASING REMOVED:
GROUND WATER READINGS			

SAMPLE NUMBER	DEPTH OF SAMPLE	BLOW COUNTS OF SAMPLER DRIVE (per 6")	C/N	RECOVERY (Inches)	DESCRIPTION OF SOIL (Color, Primary Matrix, Complementary Matrix)	DEPTH OF STRATA CHANGE
1a	0.0'-1.0'	7-6-3-3	N/9	9	Grey Crushed Stone (moist) ~Fill~	1.0
1b	1.0'-2.0'			8	Brown fine SAND, little SILT (moist, loose)	
2	2.0'-4.0'	3-3-3-2	N/6	16	Grey/Brown fine SAND, some SILT (wet, loose)	
3	4.0'-6.0'	2-1-2-1	N/3	11	Grey fine SAND, little SILT (saturated, very loose)	
4	6.0'-8.0'	1-WH-1-1	N/1	24	Similar Soil (saturated, very loose)	
5	8.0'-10.0'	2-1-2-2	N/3	21	Similar Soil (saturated, very loose)	
					Bottom of Boring @ 10.0'	

Notes: 1. Offset boring 3.0' - Augered to 5.0' bgs and set a 4" Infiltration Test Pipe. Client to perform testing.
 Key to Drilling Terms: N - No. of blows to drive sampler 12" w/ 140 lb. hammer falling / 30"; C - % of Bedrock Core Recovery

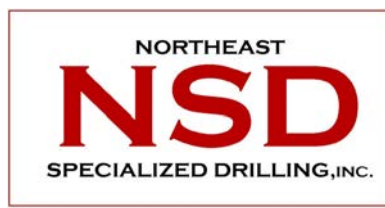

BORING LOG

PROJECT:	Syracuse Airport Parking Expansion Project	JOB NUMBER:	G029-22 PW Labs#L-22-0090
LOCATION:	Air Cargo Road - Syracuse, New York	BORING NUMBER:	B-5
CLIENT:	PW Laboratories, Inc.	SURFACE ELEVATION:	As Obtained by Client

		GROUND WATER READINGS			
		DATE STARTED:	DATE COMPLETED:	WHILE DRILLING:	Depth to Water:
		06/21/22	06/21/22		7.1'
					8.0'
DRILLER:	HELPER:			BEFORE CASING REMOVED:	Casing At:
Marc Cheney	Zack Cheney			7.1'	8.0'
CASING TYPE:			AFTER CASING REMOVED:		
2 1/4" Hollow Stem Augers				None Noted	
DRILL RIG:			CAVED AT DEPTH:		
Truck Mounted Central Mine Equipment Model 55			4.2'		

SAMPLE NUMBER	DEPTH OF SAMPLE	BLOW COUNTS OF SAMPLER DRIVE (per 6")	C/N	RECOVERY (Inches)	DESCRIPTION OF SOIL (Color, Primary Matrix, Complementary Matrix)	DEPTH OF STRATA CHANGE
1a	0.0'-0.5'	2-1-3-3	N/4	6	6" Topsoil (moist)	0.5
1b	0.5'-2.0'			10	Brown fine SAND, little SILT (moist, loose)	
2	2.0'-4.0'	2-2-1-2	N/3	21	Brown mf SAND, little SILT (moist, very loose)	
3	4.0'-6.0'	2-1-2-2	N/3	15	Grey mf SAND, trace SILT (saturated, very loose)	
4	6.0'-8.0'	2-2-2-3	N/4	24	Similar Soil (saturated, loose)	
5	8.0'-10.0'	1-1-2-2	N/3	17	Similar Soil (saturated, very loose)	
					Bottom of Boring @ 10.0'	

Notes: 1. Offset boring 3.0' - Augered to 5.0' bgs and set a 4" Infiltration Test Pipe. Client to perform testing.
 Key to Drilling Terms: N - No. of blows to drive sampler 12" w/ 140 lb. hammer falling / 30"; C - % of Bedrock Core Recovery



BORING LOG

PROJECT:	Syracuse Airport Parking Expansion Project	JOB NUMBER:	G029-22 PW Labs#L-22-0090
LOCATION:	Air Cargo Road - Syracuse, New York	BORING NUMBER:	B-6
CLIENT:	PW Laboratories, Inc.	SURFACE ELEVATION:	As Obtained by Client

				GROUND WATER READINGS		
DATE STARTED:	06/21/22	DATE COMPLETED:	06/21/22	WHILE DRILLING:	Depth to Water:	Casing At:
DRILLER:	Marc Cheney	HELPER:	Zack Cheney	BEFORE CASING REMOVED:	7.3'	8.0'
CASING TYPE:	2 1/4" Hollow Stem Augers			AFTER CASING REMOVED:	None Noted	
DRILL RIG:	Truck Mounted Central Mine Equipment Model 55			CAVED AT DEPTH:	3.9'	

SAMPLE NUMBER	DEPTH OF SAMPLE	BLOW COUNTS OF SAMPLER DRIVE (per 6")	C/N	RECOVERY (Inches)	DESCRIPTION OF SOIL (Color, Primary Matrix, Complementary Matrix)	DEPTH OF STRATA CHANGE
1a	0.0'-0.6'	1-2-2-6	N/4	7	7" Topsoil (moist)	0.6
1b	0.6'-2.0'			12	Brown fine SAND, little SILT (moist, loose)	
2	2.0'-4.0'	3-4-3-2	N/7	23	Similar Soil (moist, loose)	
3	4.0'-6.0'	1-1-1-2	N/2	20	Grey mf SAND, trace SILT (moist, very loose)	
4	6.0'-8.0'	3-2-2-2	N/4	18	Similar Soil (saturated, loose)	
5	8.0'-10.0'	1-2-1-2	N/3	24	Similar Soil (saturated, very loose)	
					Bottom of Boring @ 10.0'	

Notes: 1. Offset boring 3.0' - Augered to 5.0' bgs and set a 4" Infiltration Test Pipe. Client to perform testing.
 Key to Drilling Terms: N - No. of blows to drive sampler 12" w/ 140 lb. hammer falling / 30"; C - % of Bedrock Core Recovery

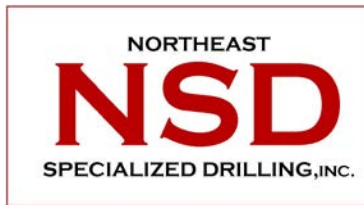

Key to Boring Logs

Burmister Classification of Soils	
Soil Description: Color, principal soil type and remaining soil types in decreasing pre-dominancy.	
Percentages By Weight:	
35-50%	and
20-35%	some
10-20%	little
0-10%	trace

Description of Soil Compactness (Based on SPT "N" Value)		
Primary Soil Type	Term of Compactness	Range of "N" Values
Coarse Grained Soils (Gravels and Sands)	Very Loose	N Value: < 4
	Loose	N Value: 4 to 9
	Medium Compact	N Value: 10 to 29
	Compact	N Value: 30 to 49
	Very Compact	N Value: \geq 50
Fine Grained Soils (Silts and Clays)	Very Soft	N Value: < 2
	Soft	N Value: 2 to 3
	Medium Stiff	N Value: 4 to 7
	Stiff	N Value: 8 to 14
	Very Stiff	N Value: 15 to 29
	Hard	N Value: \geq 30

Sample Number:

Soil - The number of the sample obtained (S-#).

Bedrock – The number of the bedrock sample obtained, referred to as a Run (R-#).

SPT "N" Value:

The number of blows of a 140 lb. weight hammer, falling 30", driving a 2" split spoon.

Recovery: Soil – Inches of soil recovered in the 2" split spoon.

Bedrock - Inches of Bedrock recovered during the core run, reported in inches and as percentage of core run.

RQD: Bedrock – Portions of the Bedrock core, full diameter and \geq 4" in length.

Reported in inches and as percentage of core run.

cheney@nsdrill.com
(315) 439-1155

www.nsdrill.com

meneilly@nsdrill.com
(315) 491-9385

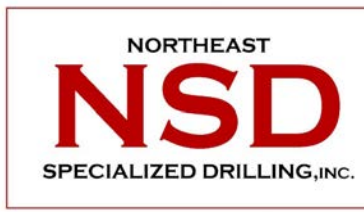

Pavement Core Summary

Client:	PW Laboratories, Inc.	Driller:	Marc Cheney
Job No.:	G029-22 -- PW Labs #L-22090	Laborer:	Zack Cheney
Location:	Syracuse Airport Parking Expansion Project Air Cargo Road - Syracuse, New York	Date:	June 20, 2022

Core I.D.	Depth of Core (in)
C-1	5.50
C-2	5.00
C-3	5.75
C-4	4.75
C-5	6.25
C-6	6.00

Notes: _____

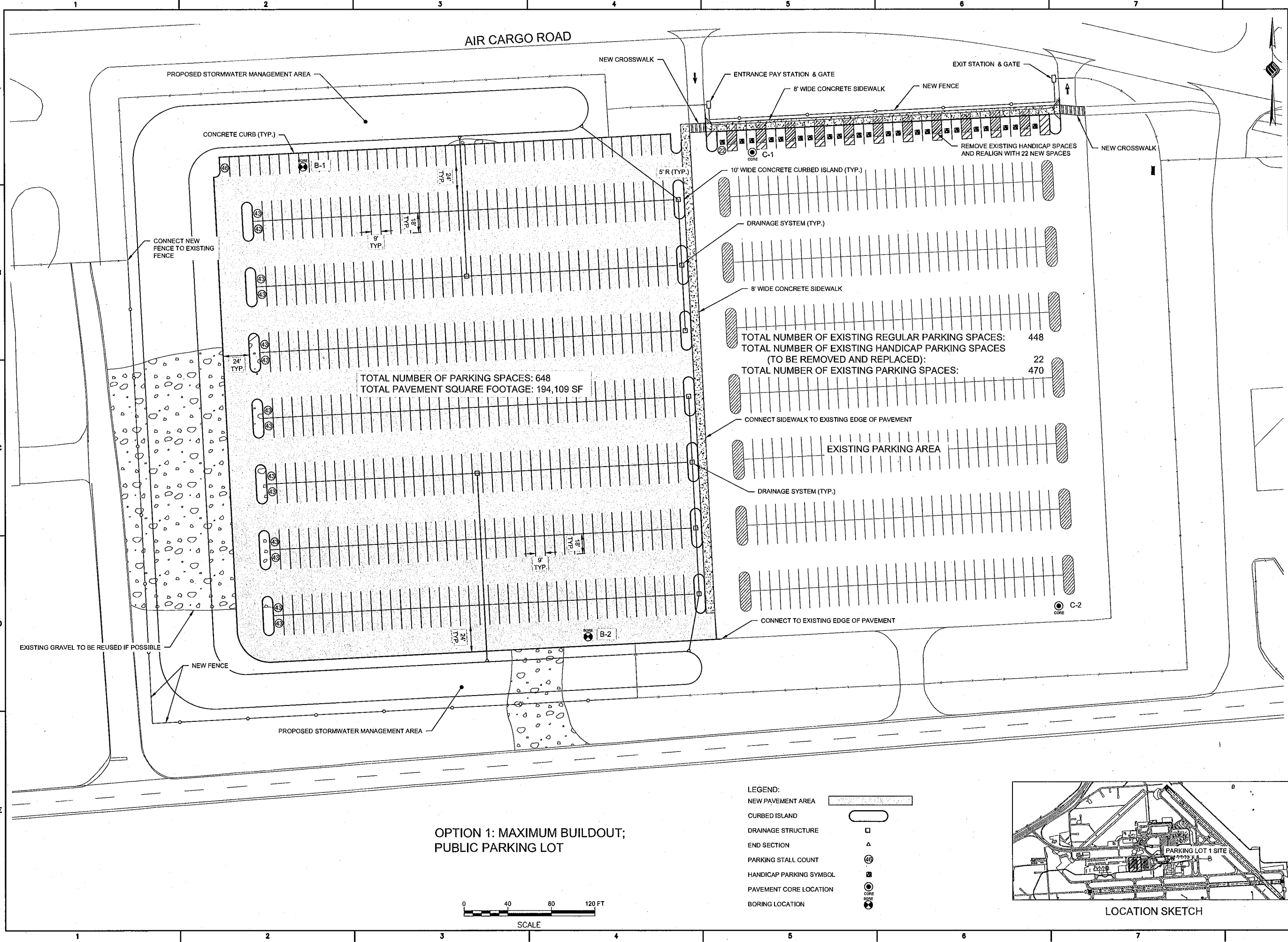

McFarland Johnson
 Engineers, Planning & Construction Administration
 15 FISHERS ROAD, SUITE 200
 PITTSFORD, NEW YORK 14534
 P:585-905-0970 F:585-905-0882
 Pittsford@mjinc.com

PROJECT MILESTONE

NO.	DATE	DESCRIPTION
		CONCEPT PLAN

CLIENT: SYRACUSE AIRPORT
 SYRACUSE, NEW YORK

PROJECT: SYRACUSE AIRPORT PARKING LOTS

DRAWN	LDW
DESIGNED	LDW
CHECKED	AJF
SCALE	1"=40'
DATE	JUNE 2022
PROJECT	18831.02

IT IS A VIOLATION OF LAW FOR ANY PERSON, UNLESS THEY ARE ACTING UNDER THE DIRECT DIRECTION OF A LICENSED PROFESSIONAL ENGINEER, ARCHITECT, LANDSCAPE ARCHITECT, OR LAND SURVEYOR, TO ALTER AN ITEM IN ANY WAY. IF AN ITEM BEARING THE STAMP OF A LICENSED PROFESSIONAL IS ALTERED, THE ALTERING ENGINEER, ARCHITECT, LANDSCAPE ARCHITECT, OR LAND SURVEYOR SHALL STAMP THE DOCUMENT AND INCLUDE THE NOTATION "ALTERED BY" FOLLOWED BY THEIR SIGNATURE, THE DATE OF SUCH ALTERATION, AND A SPECIFIC DESCRIPTION OF THE ALTERATION.

DRAWING TITLE
SITE PLAN; PARKING LOT 1; OPTION 1

DRAWING NUMBER
SP-01-1
 1 OF 4

**OPTION 1: MAXIMUM BUILDOUT;
 PUBLIC PARKING LOT**

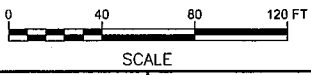

- LEGEND:**
- NEW PAVEMENT AREA [Hatched Box]
 - CURBED ISLAND [Oval]
 - DRAINAGE STRUCTURE [Square]
 - END SECTION [Triangle]
 - PARKING STALL COUNT [Circle with 49]
 - HANDICAP PARKING SYMBOL [Circle with P]
 - PAVEMENT CORE LOCATION [Circle with CORE]
 - BORING LOCATION [Circle with B]

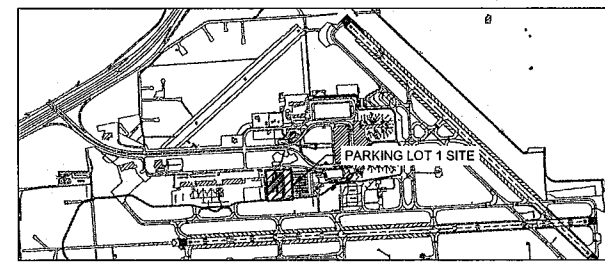

LOCATION SKETCH

K:\SYRACUSE\18831.02\NEW PARKING LOTS - DESIGN\DRAWINGS\DWGSET FILE\18831.02\1.DWG

PROJECT MILESTONE
CONCEPT PLAN

NO.	DATE	DESCRIPTION

CLIENT: **SYRACUSE AIRPORT**
 SYRACUSE, NEW YORK

PROJECT: **SYRACUSE AIRPORT PARKING LOTS**

DRAWN	LDW
DESIGNED	LDW
CHECKED	AJF
SCALE	1"=40'
DATE	JUNE 2022
PROJECT	18831.02

IT IS A VIOLATION OF LAW FOR ANY PERSON, UNLESS THEY ARE ACTING UNDER THE DIRECT DIRECTION OF A LICENSED PROFESSIONAL ENGINEER, ARCHITECT, LANDSCAPE ARCHITECT, OR LAND SURVEYOR, TO ALTER AN ITEM IN ANY WAY. IF AN ITEM BEARING THE STAMP OF A LICENSED PROFESSIONAL IS ALTERED, THE ALTERING ENGINEER, ARCHITECT, LANDSCAPE ARCHITECT, OR LAND SURVEYOR SHALL STAMP THE DOCUMENT AND INCLUDE THE NOTATION "ALTERED BY" FOLLOWED BY THEIR SIGNATURE, THE DATE OF SUCH ALTERATION, AND A SPECIFIC DESCRIPTION OF THE ALTERATION.

DRAWING TITLE
SITE PLAN; PARKING LOT 2; OPTION 1

DRAWING NUMBER
SP-02-1
 3 OF 4

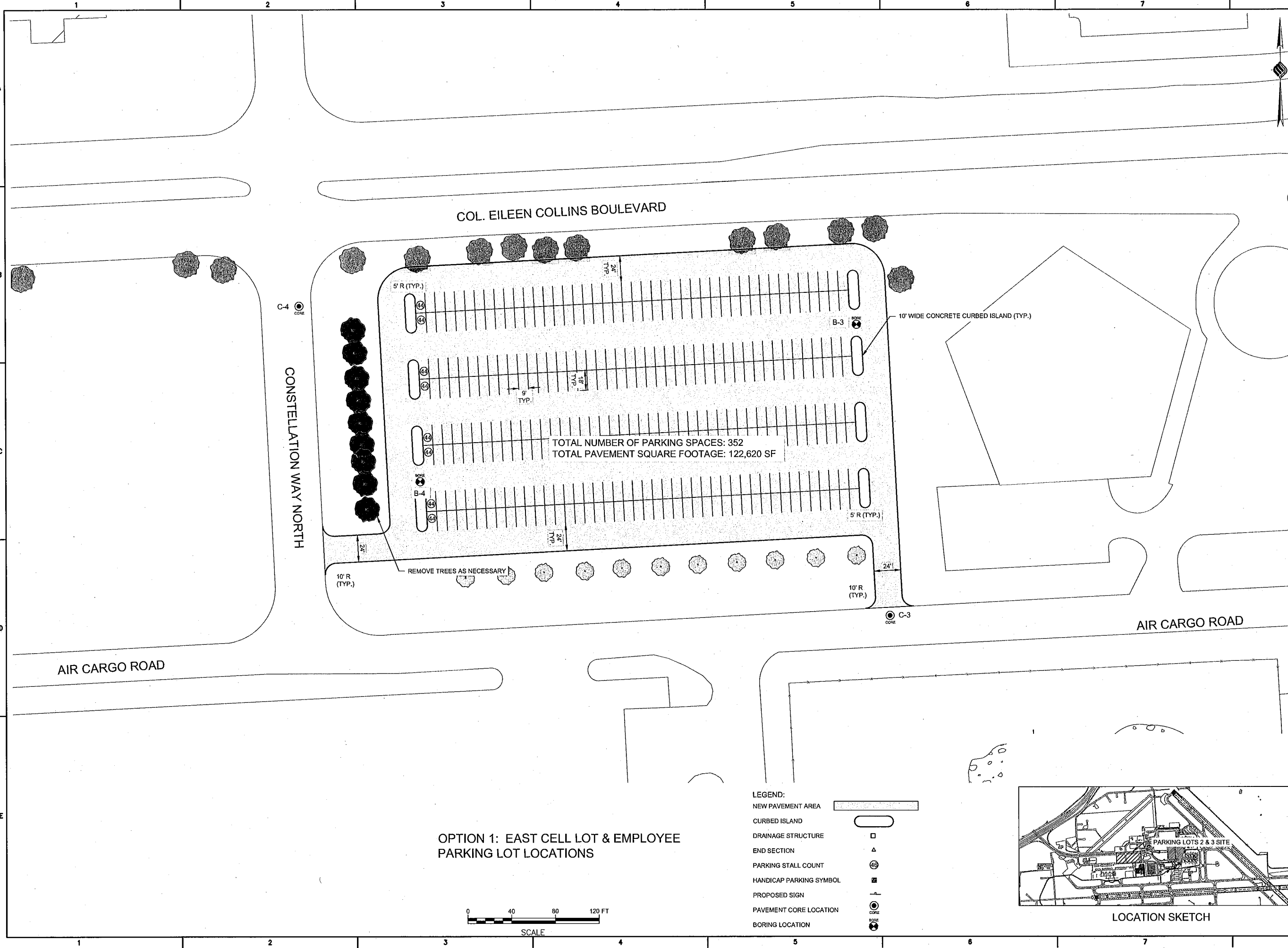

OPTION 1: EAST CELL LOT & EMPLOYEE PARKING LOT LOCATIONS

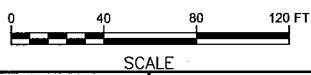

- LEGEND:**
- NEW PAVEMENT AREA [shaded rectangle]
 - CURBED ISLAND [rounded rectangle]
 - DRAINAGE STRUCTURE [square]
 - END SECTION [triangle]
 - PARKING STALL COUNT [circle with number]
 - HANDICAP PARKING SYMBOL [square with 'H']
 - PROPOSED SIGN [circle with 'S']
 - PAVEMENT CORE LOCATION [circle with 'C']
 - BORING LOCATION [circle with 'B']

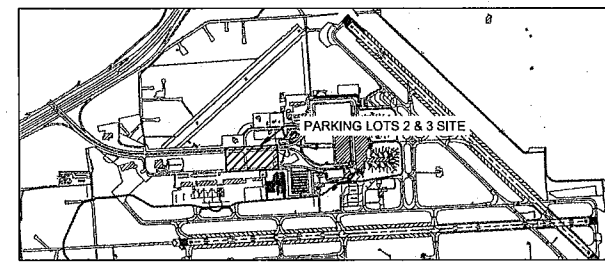

K:\PROJECTS\18831\18831_02_NEW PARKING LOTS - DESIGN\DWG\18831_02_PARKING LOTS - DESIGN.DWG

PROJECT MILESTONE
CONCEPT PLAN

NO.	DATE	DESCRIPTION

CLIENT: **SYRACUSE AIRPORT**
 SYRACUSE, NEW YORK

PROJECT: **SYRACUSE AIRPORT PARKING LOTS**

DRAWN	
DESIGNED	
CHECKED	
SCALE	
DATE	JUNE 2022
PROJECT	18831.02

IT IS A VIOLATION OF LAW FOR ANY PERSON, UNLESS THEY ARE ACTING UNDER THE DIRECT DIRECTION OF A LICENSED PROFESSIONAL ENGINEER, ARCHITECT, LANDSCAPE ARCHITECT, OR LAND SURVEYOR, TO ALTER AN ITEM IN ANY WAY. IF AN ITEM BEARING THE STAMP OF A LICENSED PROFESSIONAL IS ALTERED, THE ALTERING ENGINEER, ARCHITECT, LANDSCAPE ARCHITECT, OR LAND SURVEYOR SHALL STAMP THE DOCUMENT AND INCLUDE THE NOTATION "ALTERED BY" FOLLOWED BY THEIR SIGNATURE, THE DATE OF SUCH ALTERATION, AND A SPECIFIC DESCRIPTION OF THE ALTERATION.

DRAWING TITLE
SITE PLAN; PARKING LOT 3; OPTION 1

DRAWING NUMBER
SP-03-1
 --- OF 4

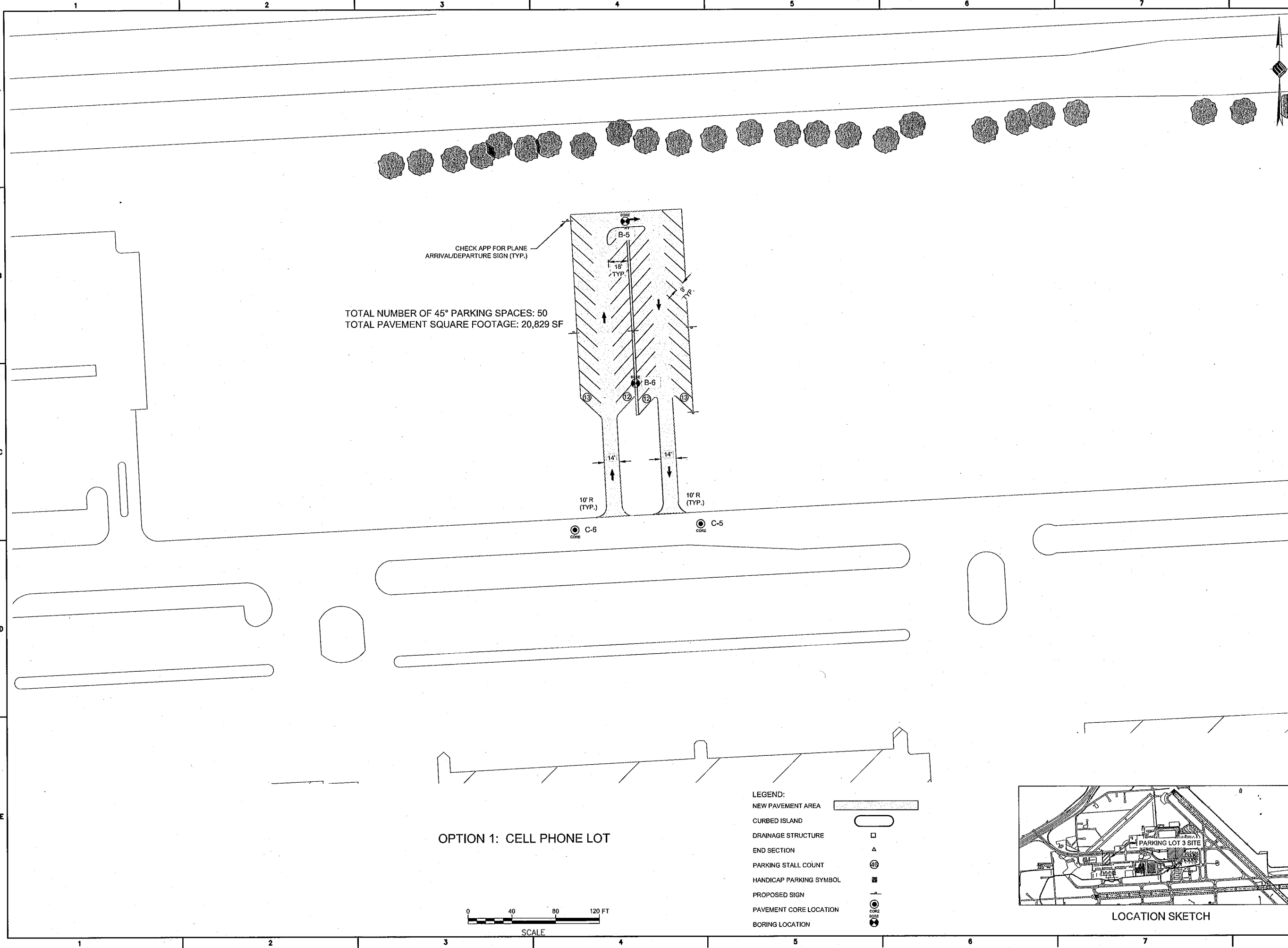

TOTAL NUMBER OF 45° PARKING SPACES: 50
 TOTAL PAVEMENT SQUARE FOOTAGE: 20,829 SF

CHECK APP FOR PLANE ARRIVAL/DEPARTURE SIGN (TYP.)

OPTION 1: CELL PHONE LOT

- LEGEND:**
- NEW PAVEMENT AREA
 - CURBED ISLAND
 - DRAINAGE STRUCTURE
 - END SECTION
 - PARKING STALL COUNT
 - HANDICAP PARKING SYMBOL
 - PROPOSED SIGN
 - PAVEMENT CORE LOCATION
 - BORING LOCATION

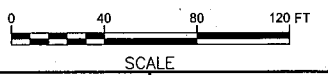
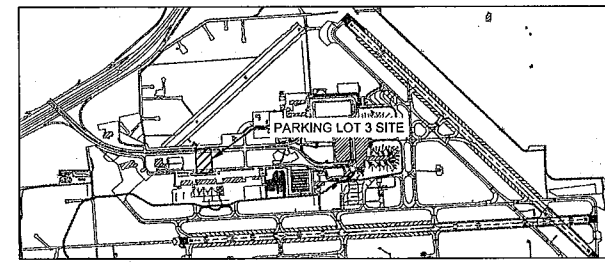

K:\PROJECTS\18831.02 NEW PARKING LOTS - DESIGN\DWG\WORKSHEET FILES\DWG\SP-03-1.DWG



DRAFT



Surface Lot Parking Design

Proposed Surface Parking Lots

- 1 Surface Lot Expansion 1
Approximate Acreage: 7.33 Acres
- 2 Surface Lot Expansion 2
Approximate Acreage: 4.57 Acres
- 3 Surface Lot Expansion 3
Approximate Acreage: 1.71 Acres